



**Wildlife and Countryside Act 1981**

**Dorset Council  
County of Dorset Definitive Map and Statement of Rights of Way**

**Dorset Council (Bridleway 8, Turnworth to be upgraded to Restricted Byway)  
Definitive Map and Statement Modification Order 2025**

This Order is made by Dorset Council under section 53(2)(b) of the Wildlife and Countryside Act 1981 ("the Act") because it appears to that authority that the County of Dorset Definitive Map and Statement require modification in consequence of the occurrence of an event specified in section 53(3)(c)(ii) namely, that a highway shown in the map and statement as a highway of a particular description ought to be there shown as a highway of a different description and section 53(3)(c)(iii) namely, that any other particulars contained in the map and statement require modification.

The authority has consulted with every local authority whose area includes the land to which the Order relates. Dorset Council hereby order that:

1. For the purposes of this Order the relevant date is 23 May 2023.
2. The County of Dorset Definitive Map and Statement shall be modified as described in Part I and Part II of the Schedule and shown on the map attached to the Order.
3. This Order shall take effect on the date it is confirmed and may be cited as the "Dorset Council (Bridleway 8, Turnworth to be upgraded to Restricted Byway) Definitive Map and Statement Modification Order 2025".

## SCHEDULE

(The points specified relate to the map attached to the Order and their positions are identified by national grid references)

### Part I

#### **Modification of definitive map Description of way to be upgraded to restricted byway**

##### Bridleway 8, Turnworth:

*(To be numbered Restricted Byway 8, Turnworth)*

I – J – K – From Bridleway 14, Okeford Fitzpaine at point I (ST 80440875), north east along a crushed stone track to point J (ST 80560888), east north east to its junction with Footpath 57 at point K (ST 80750897), continuing north east between farm buildings at point K1 (ST 81000919), then continuing east north east along the south boundary of the Okeford Hill car park and picnic site to its junction with the C32 County Road at point L (ST 81250932).  
(No recorded width)  
Limitation Point L (ST 81250932) Bridle gate.

### Part II

#### **Modification of definitive statement Variation of particulars of way**

##### Bridleway 8, Turnworth:

###### **Delete:**

From: 80440876 To: 81260933

From Junction with Path No 14, Okeford Fitzpaine generally north east along track to classified road on Okeford Hill, opposite Path No 1, Turnworth.

##### Restricted Byway 8, Turnworth:

###### **Add:**

From: ST 80440875 To: ST 81250932

From its junction with Bridleway 14, Okeford Fitzpaine at ST 80440875, north east along a crushed stone track to ST 80560888, east north east to its junction with Footpath 57 at ST 80750897, continuing north east between farm buildings at ST 81000919, then continuing east north east along the south boundary of the Okeford Hill car park and picnic site to its junction with the C32 County Road at ST 81250932, opposite Bridleway 1, Turnworth.

Dated this 24 day of January 2025

30/25

THE COMMON SEAL OF  
DORSET COUNCIL

was fixed in the presence of:-



Authorised Signatory

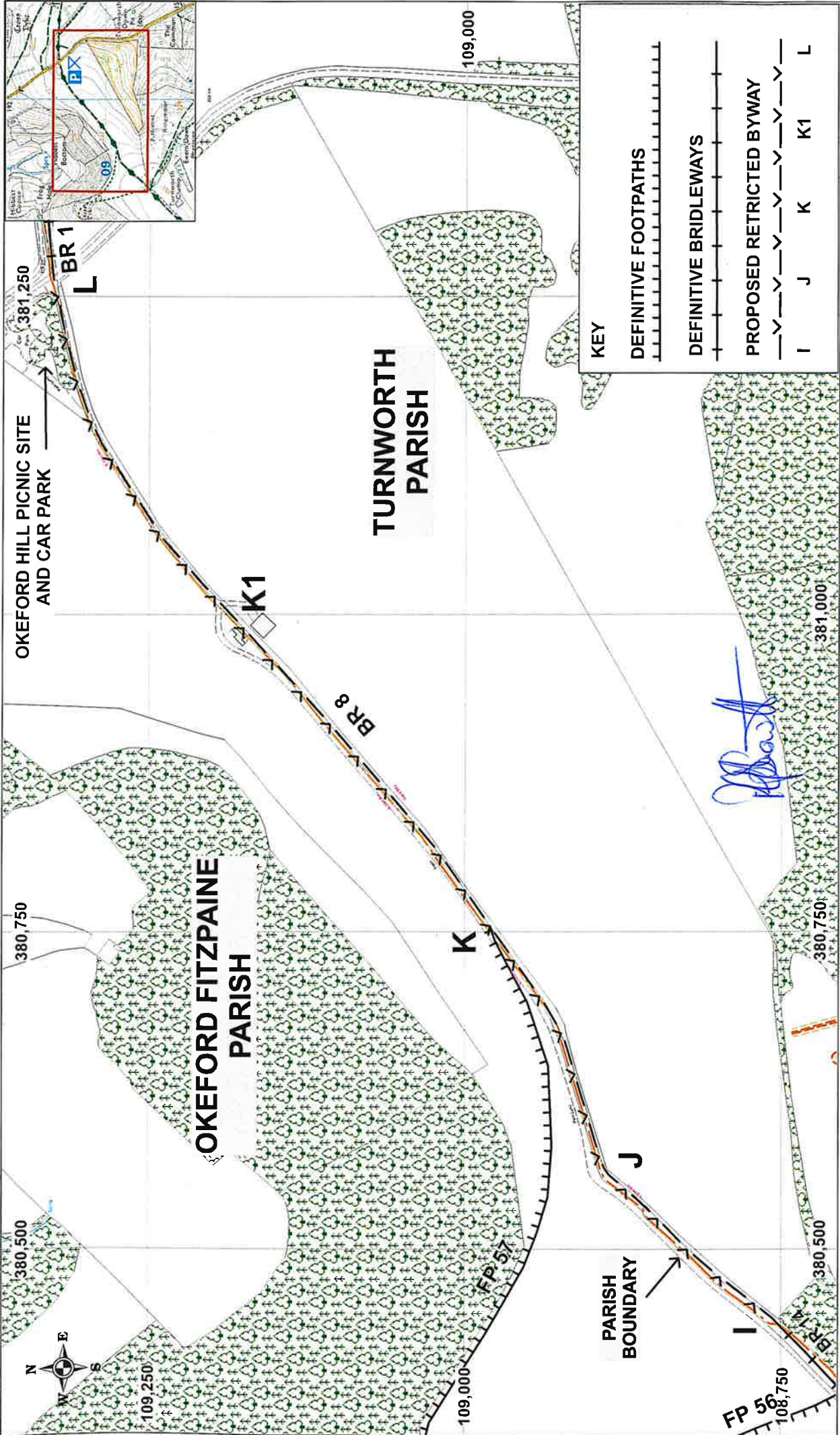

**KEY**

	DEFINITIVE FOOTPATHS			
	DEFINITIVE BRIDLEWAYS			
	PROPOSED RESTRICTED BYWAY			
<b>I</b>	<b>J</b>	<b>K</b>	<b>K1</b>	<b>L</b>

**Dorset Council**

© Crown copyright and database rights 2025  
 OS 0100060963, Aerial Photography ©  
 UK Perspectives 2002 & © Gelmapping 2005, 2009  
 & 2014, © Gelmapping Plc and Bluesky International  
 Limited (2017 onwards)

**Ref: T387/25/1**  
**Date: 06/12/2024**  
**Scale: 1:4000 at A4**  
**Drawn by: AH**  
**Cent X: 380,917**  
**Cent Y: 109,035**

**GRID REFERENCES**

**I ST 80440875**  
**J ST 80560888**  
**K ST 80750897**  
**K1 ST 81000919**  
**L ST 81250932**

**Dorset Council (Bridleway 8, Turnworth to be upgraded to Restricted Byway) Definitive Map Modification Order 2025**