

# Viewport 1

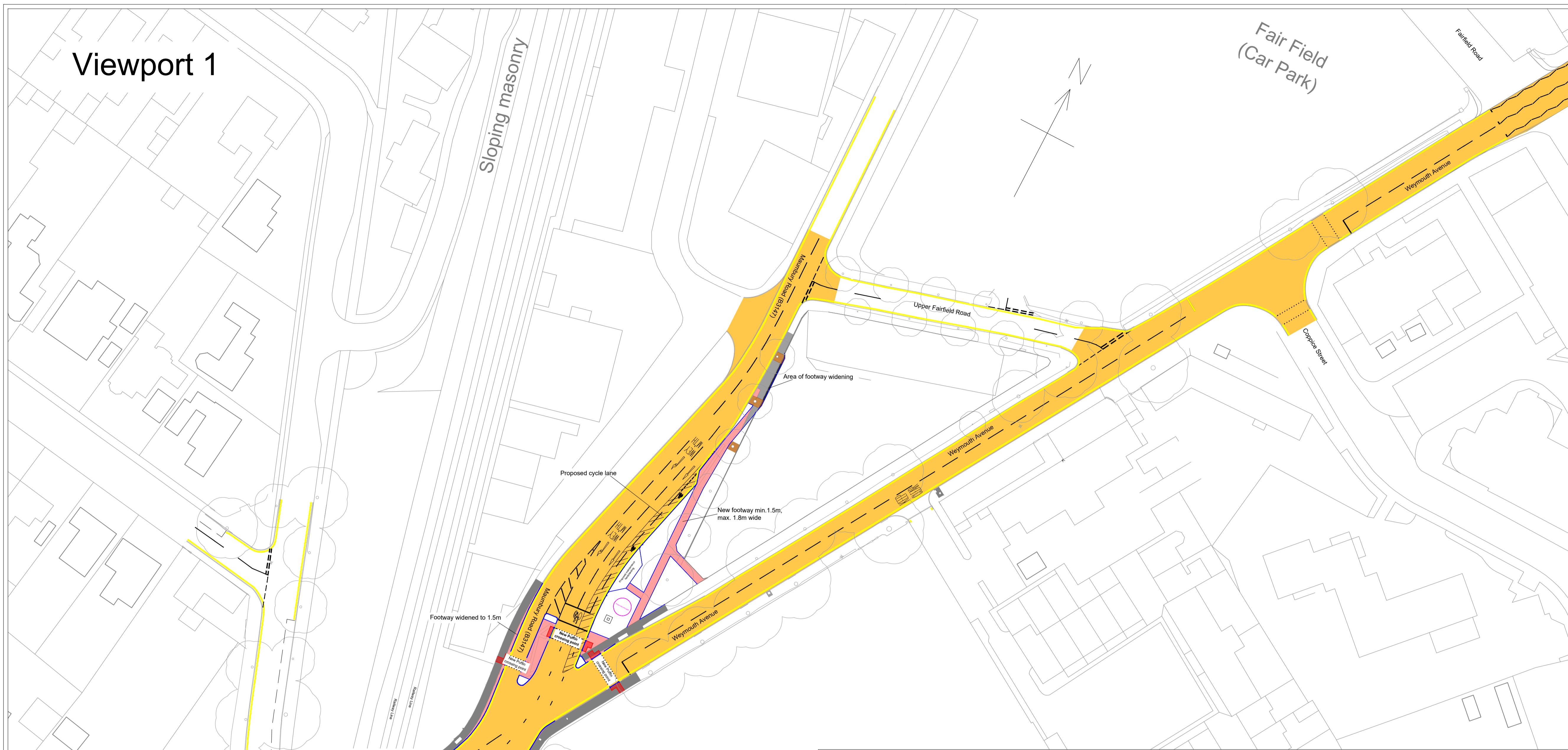

- NOTES:**
- DO NOT SCALE FROM THIS DRAWING.
  - Junction to be improved with new signal equipment providing improved efficiencies, additional crossings and improved reliability
  - New Puffin Crossing widths are 2.4m.
  - Existing No Right Turn from Weymouth Avenue southbound into Maumbury Road (B3147) to be retained.
  - Existing No Left Turn from Maumbury Road (B3147) into Weymouth Avenue (north) to be retained.

**Key:**

	New Kerb Lines
	Existing Footway to be Resurfaced
	Widening of Existing or New Footway
	New Red Tactile Paving
	New Buff Tactile Paving
	Jungle Mulch™ tree root protection around base of trees
	New Bus Shelter
	Carriageway to be resurfaced
	New carriageway construction

# Viewport 2

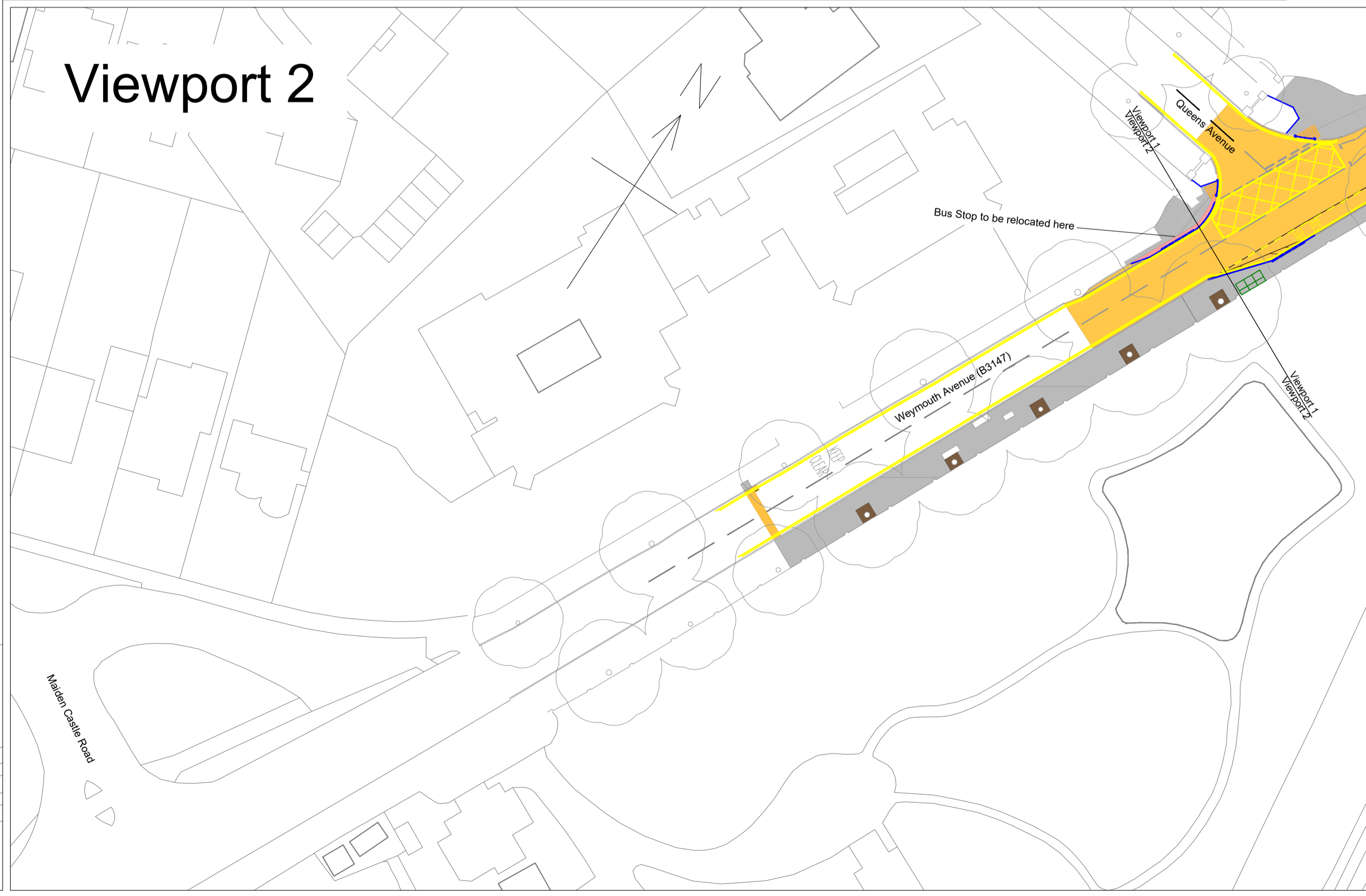

© Crown Copyright and database rights  
2021 OS 0100060963

Orig	Date	Issue / Remarks	Checked
23Oct24		Replaces the HI1090/0130 drawings	ZM



**DORSET HIGHWAYS**  
**Matthew Piles**  
Economy Infrastructure and Growth

Project Title	MAUMBURY CROSS IMPROVEMENTS		
Drawing Title	GENERAL ARRANGEMENT OF PROPOSED WORKS		
Scale (A1 Size)	1:500	Drawn By	MDP
		Date	15 Oct 2024
Drawing Number	HI1090/0131/01/Orig		
Drawing Status	CONSTRUCTION		